



Backwash Chairs

INSTRUCTION MANUAL



List of Parts and Tools

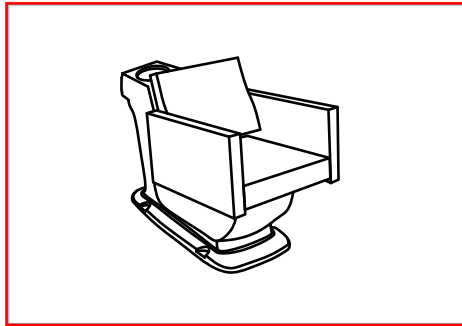

101001

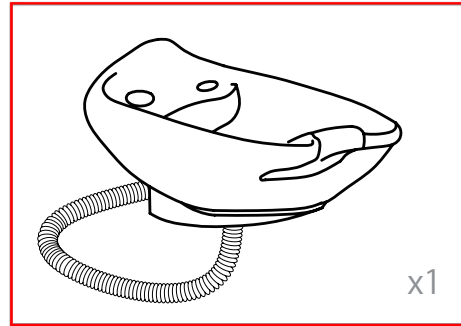

0350/0356

x1

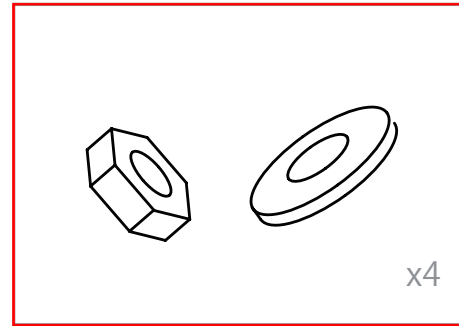

101003

x4

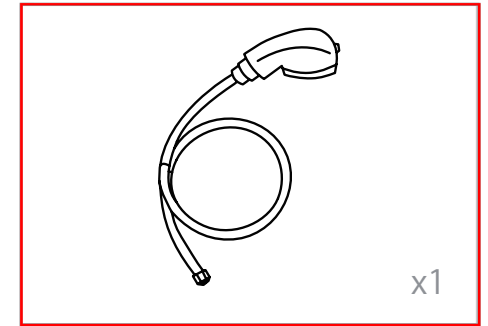

101004

x1

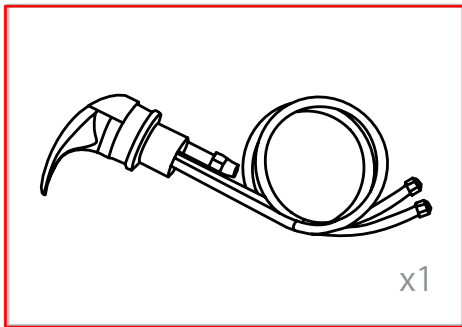

101005

x1

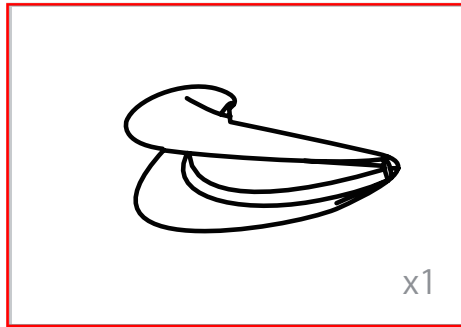

101006

x1

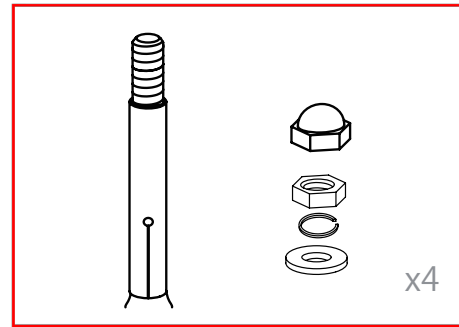

101007

x4

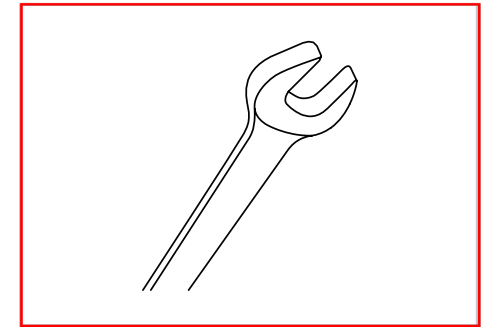

101008

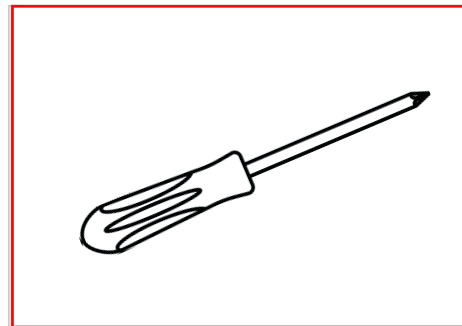

101009

Type	USA size	UK size
Water supply lines Adapter	$\frac{5}{8}$ "	$\frac{1}{2}$ "
Drain Hose Connector	$1 \frac{1}{4}$ "	3.2cm

STEP 1

0350

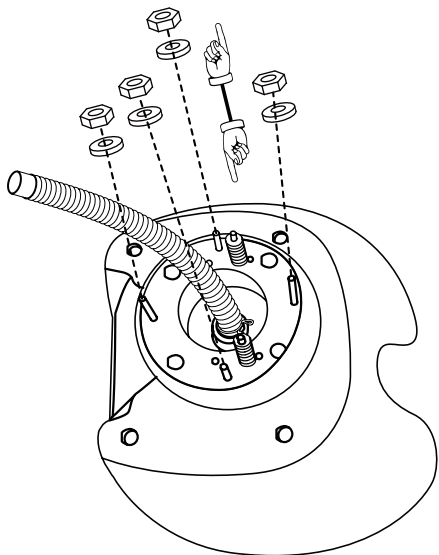

Front

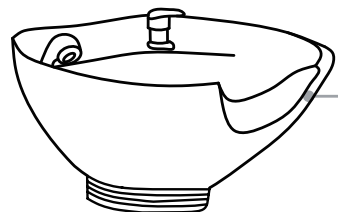
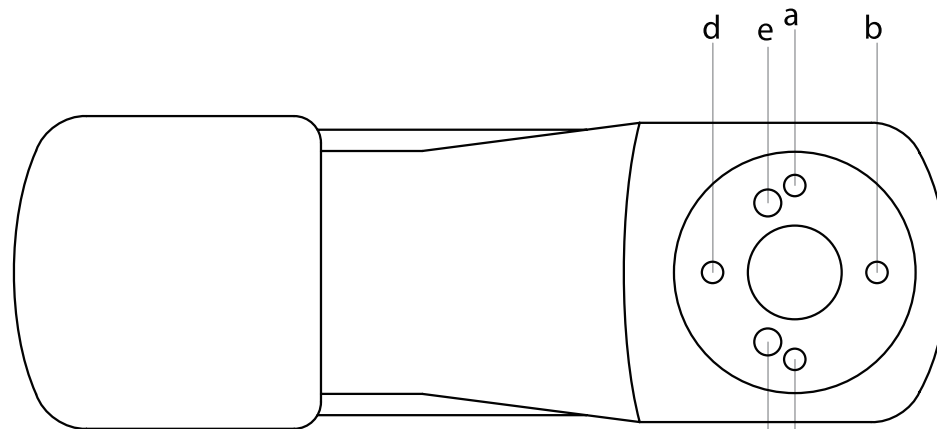

Sink

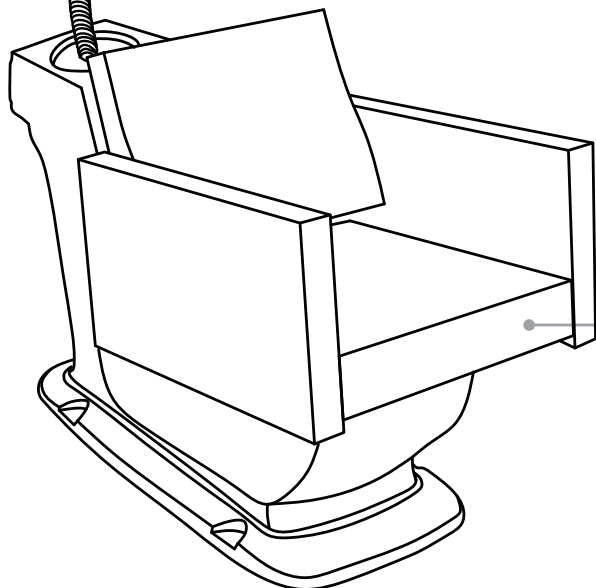

Base

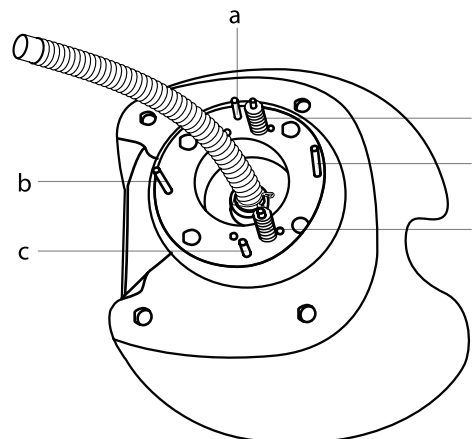

Sink

Front

Align the sink to the base as shown in the diagram.

STEP 2

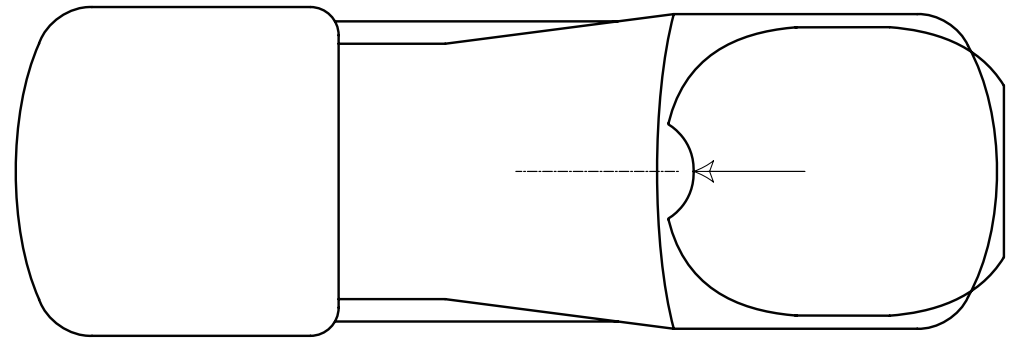
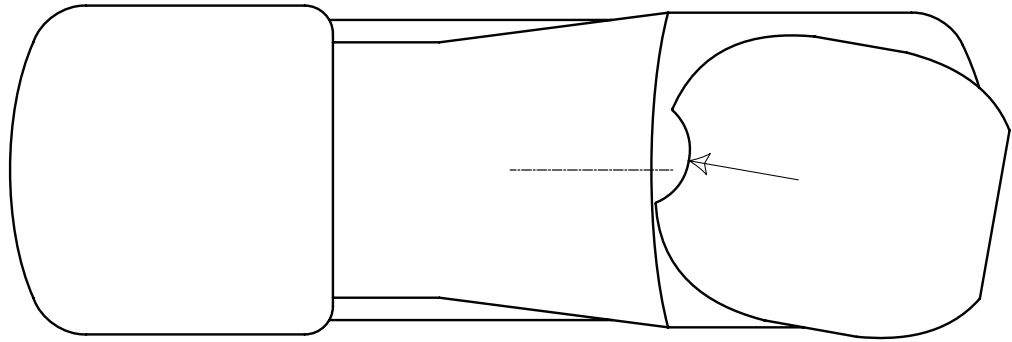
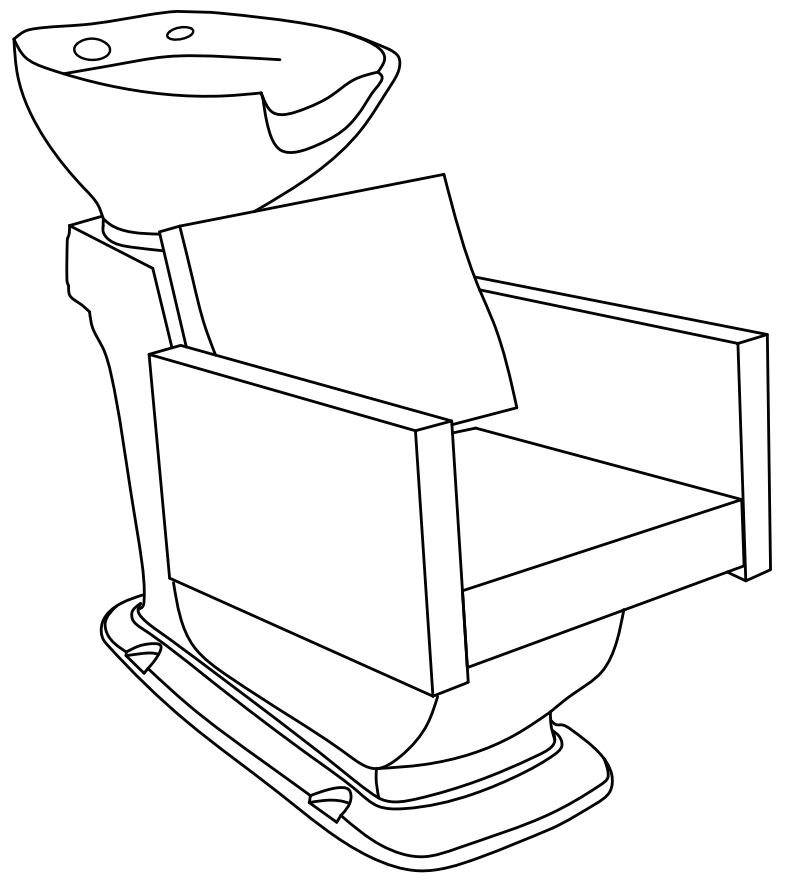

STEP 3

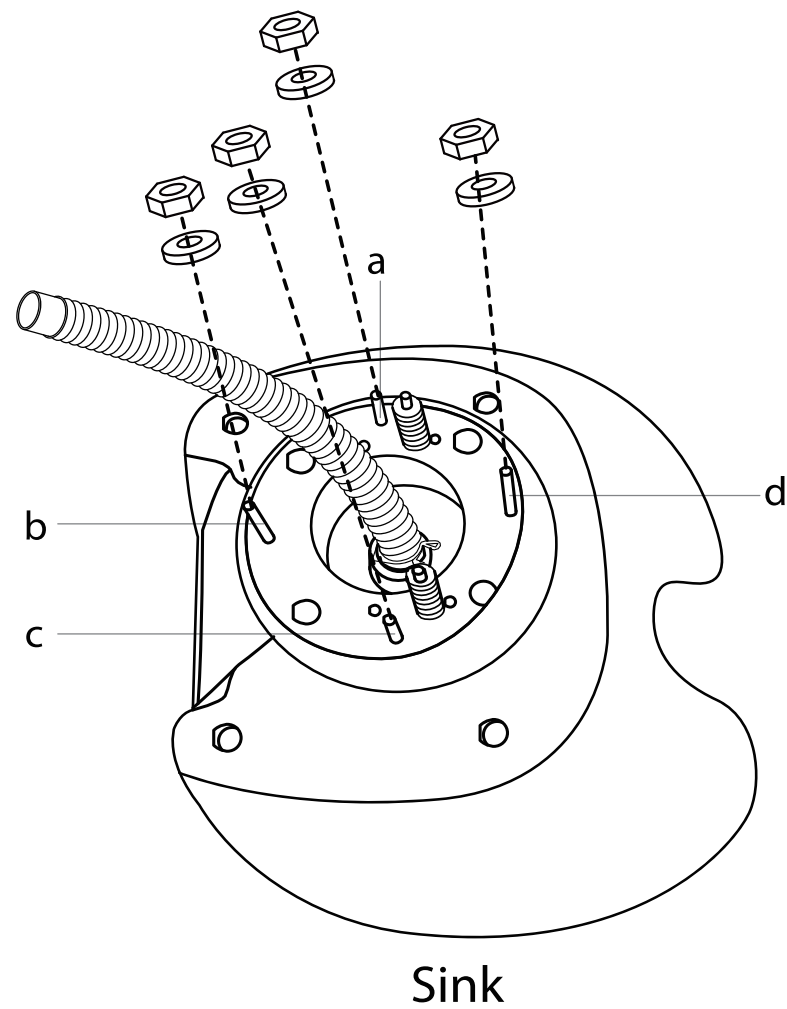
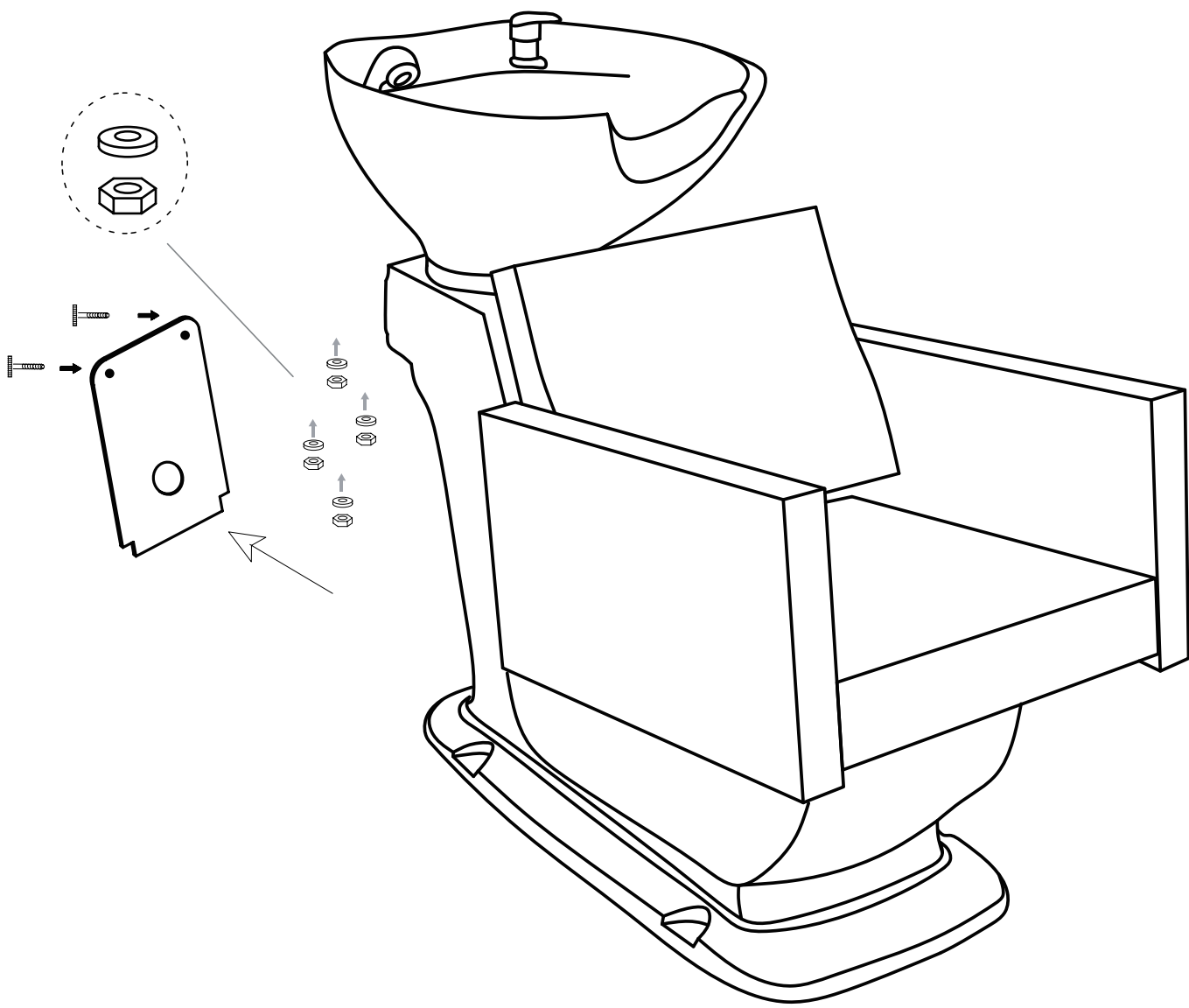

Undo the access panel by twisting clockwise then using the 4* 14mm washers & gaskets provided fasten the sink to the base.

ASSEMBLY INSTRUCTION 4

Faucet Set up



None Vacuum Breaker Sink

0350

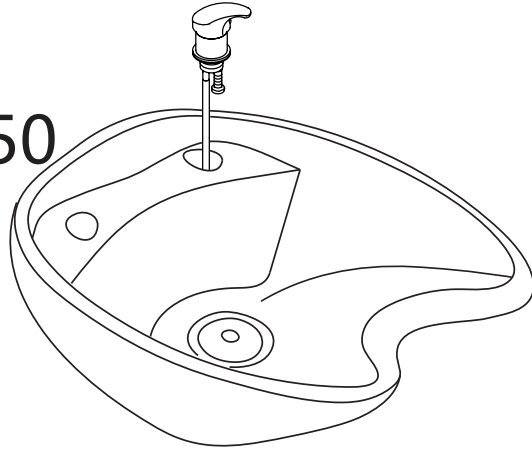

Vacuum Breaker Sink

0388

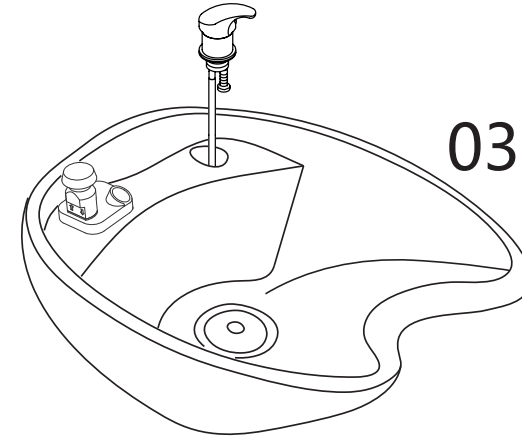

or

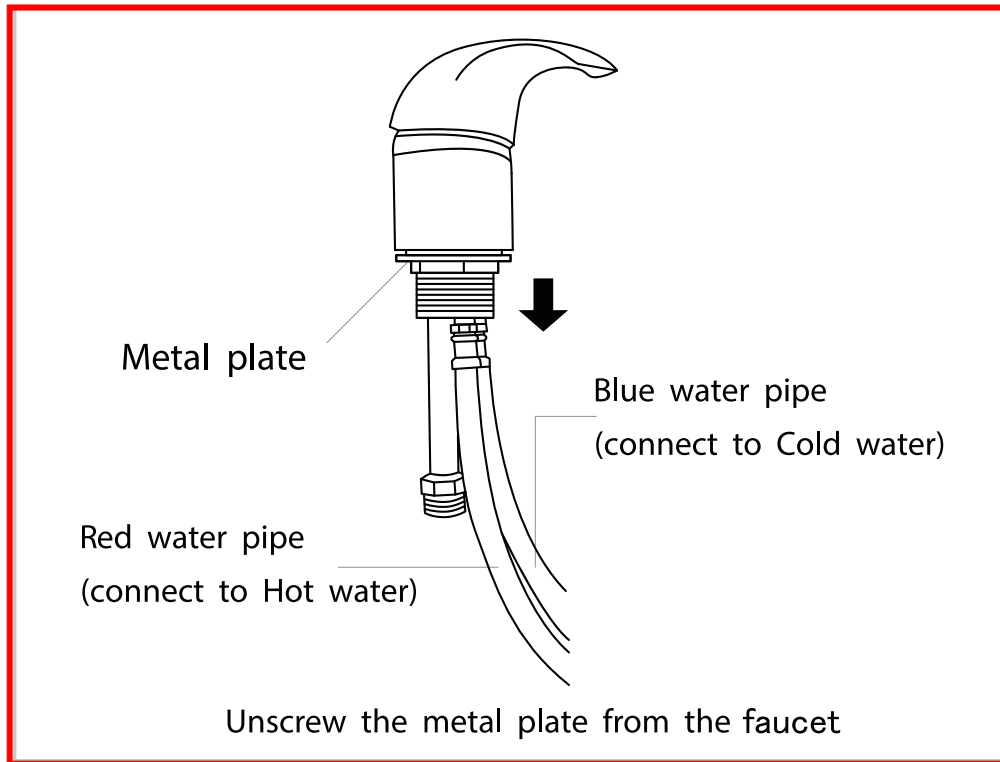

STEP 1

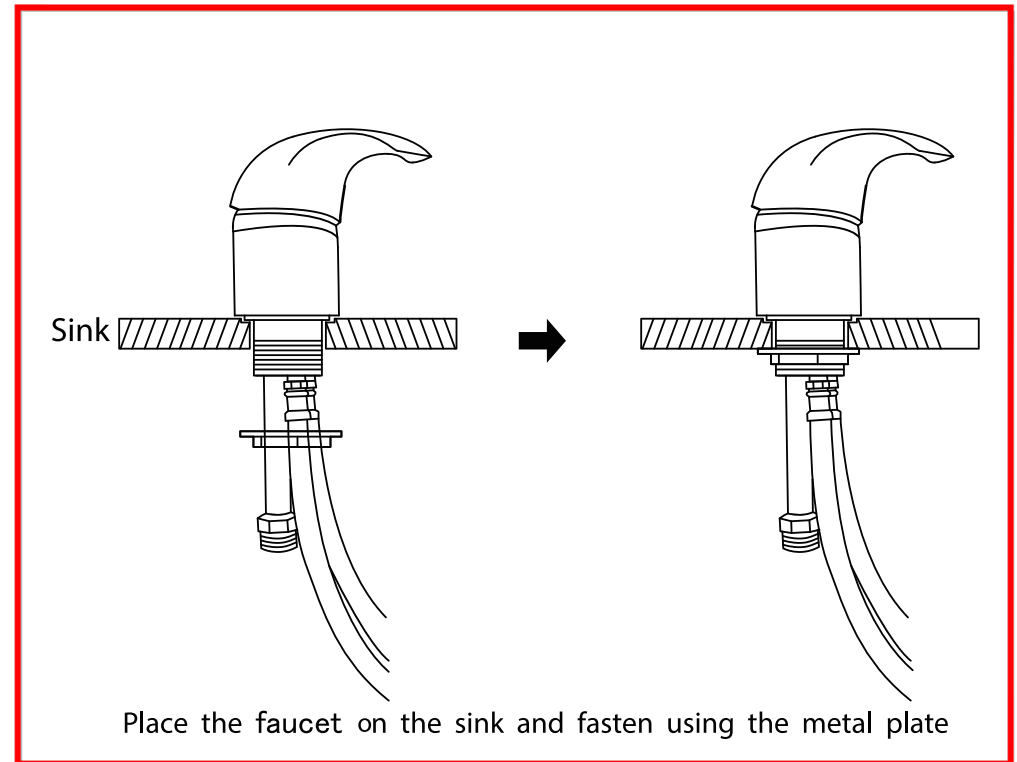

STEP 2

ASSEMBLY INSTRUCTION 5

Sprayer Set Up Vacuum Breaker Sink

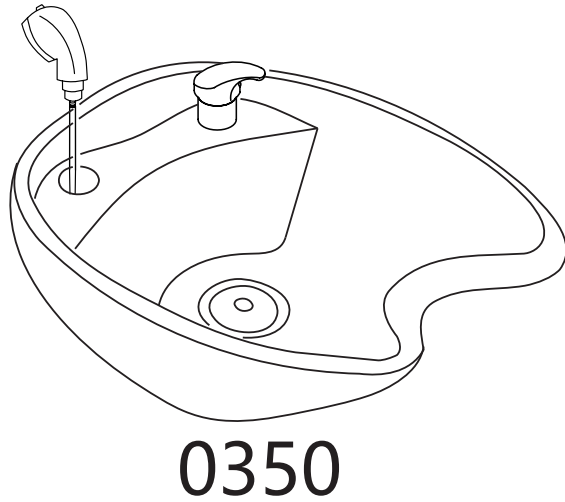

0350

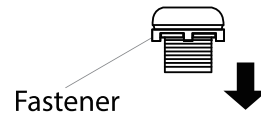

Unscrew the fastener from the sprayerhead holder.

STEP 1

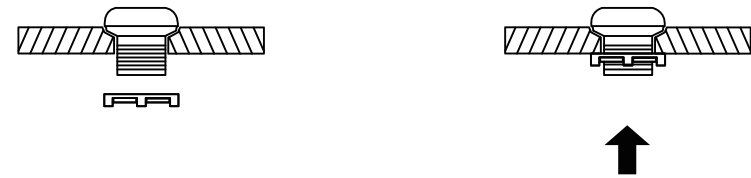

Fasten the sprayerhead holder to the sink with the plastic fastener.

STEP 2

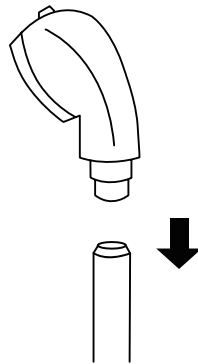

Unscrew the sprayerhead from the sprayer hose.

STEP 3

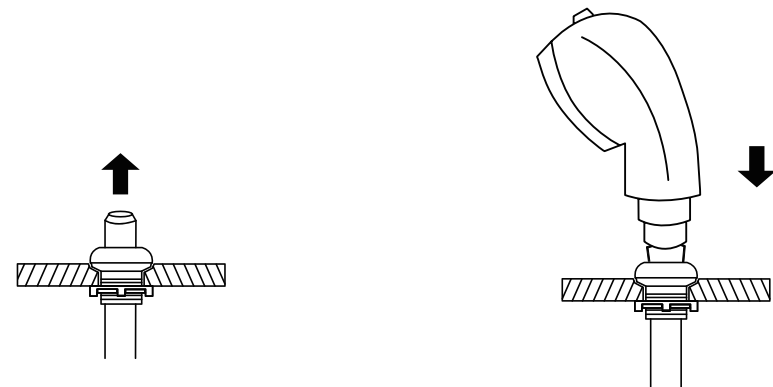

Place the sprayer hose from underneath through the sprayerhead holder and fasten the sprayerhead to the sprayer hose.

STEP 4

ASSEMBLY INSTRUCTION 6

Sprayer Set Up None Vacuum Breaker Sink

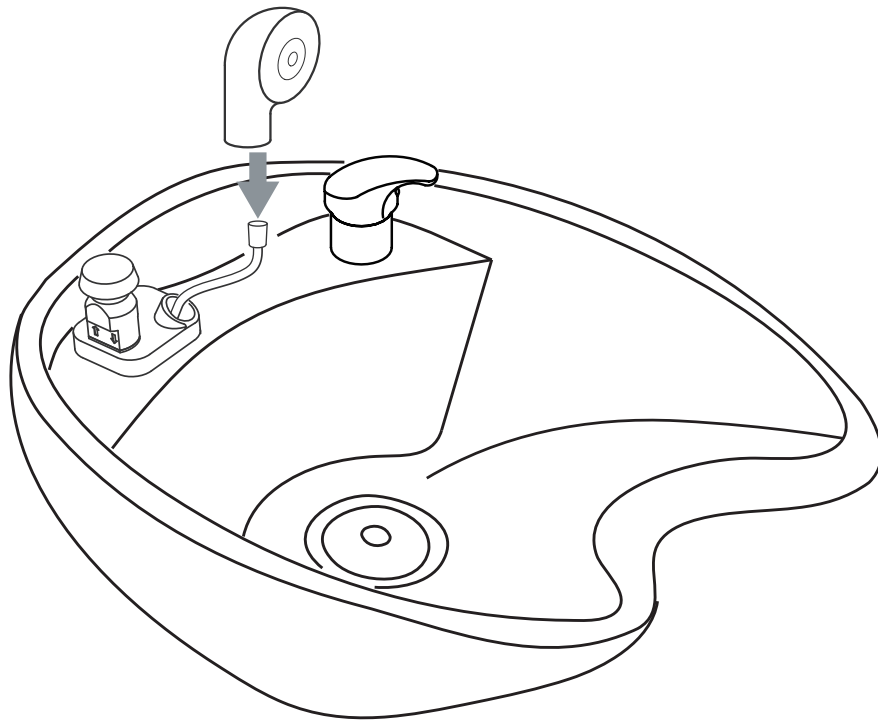

0388

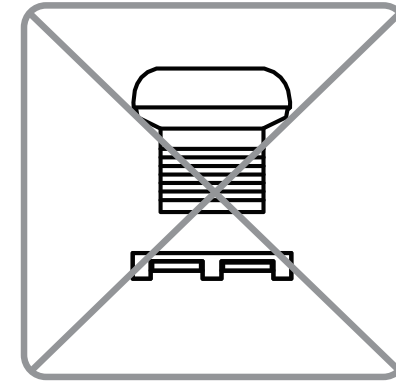

no need

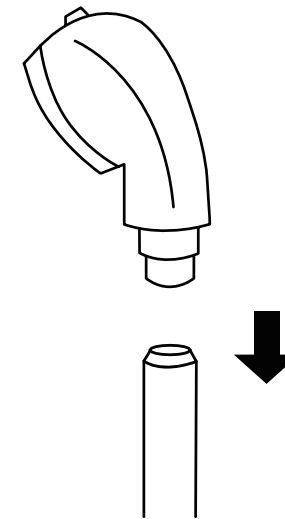

Unscrew the sprayerhead from the sprayer hose.

Plumbing setup:

*removable back panel to route both water supply lines and make all connections.

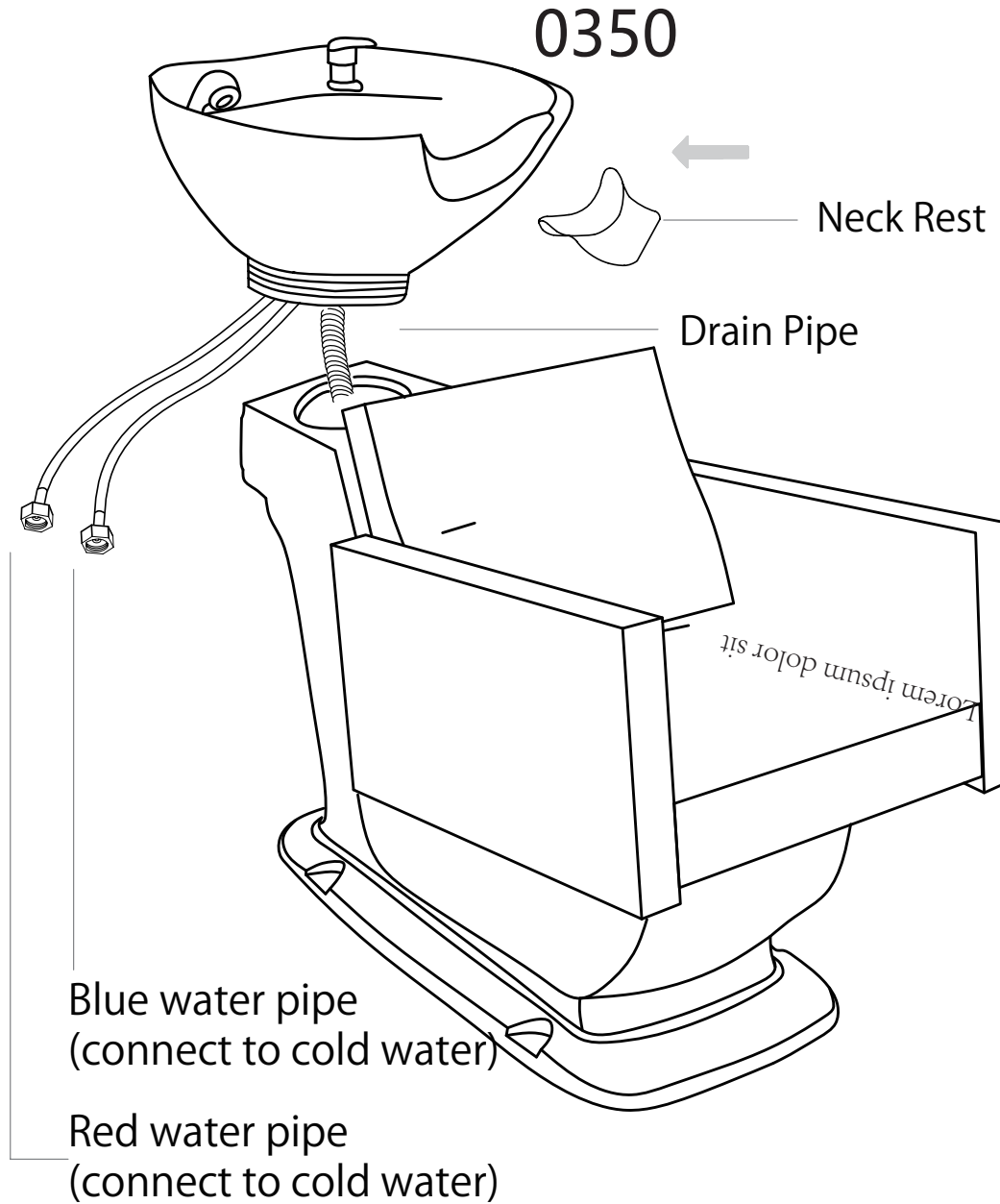

Wall plumbing setup:
 Circle opening on removable back for drain pipe exit

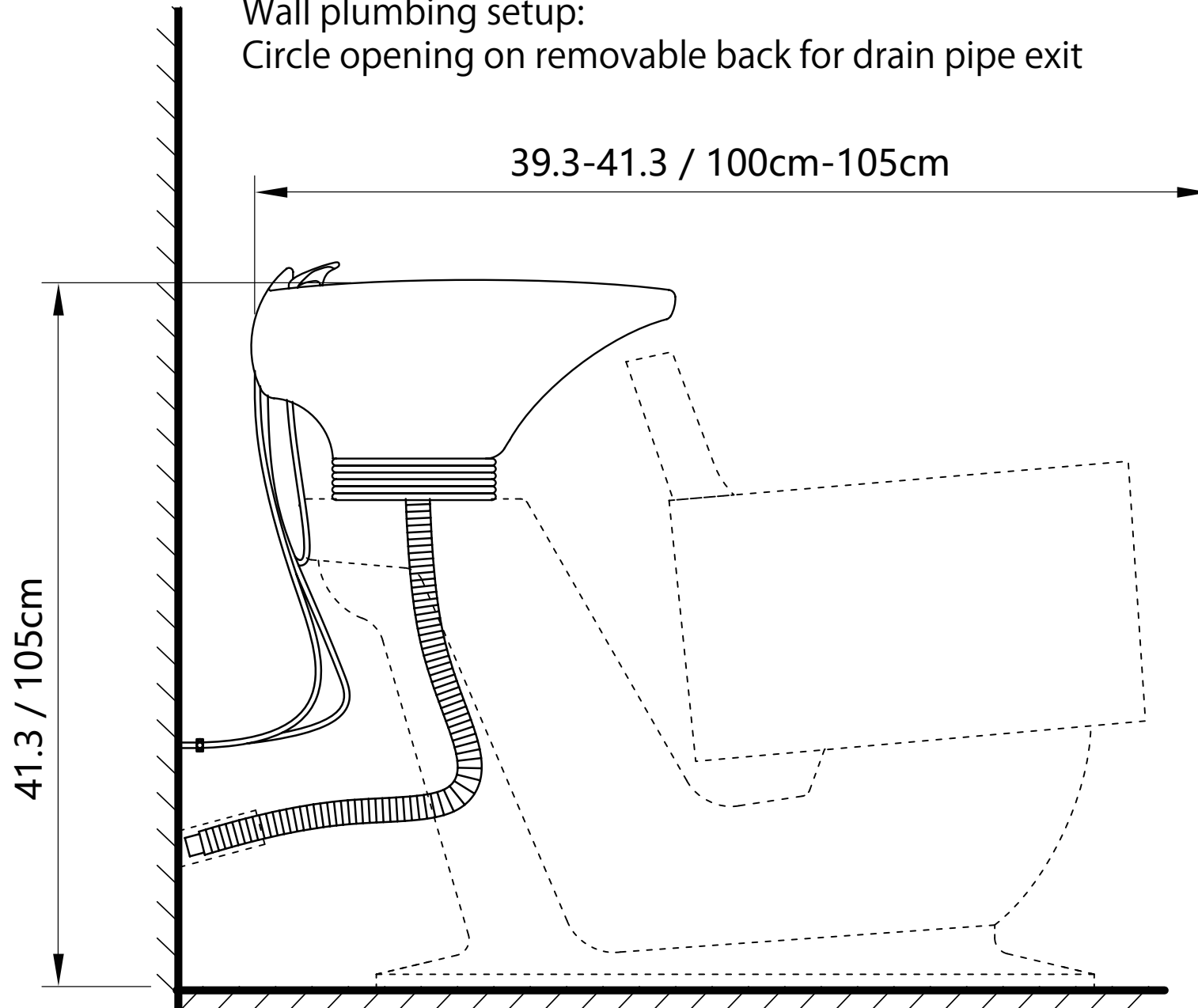

Please leave minimum $7 \frac{7}{8}$ / 20cm of space measuring from finished wall to the back of the sink to allow sinks tilting position.

Floor plumbing setup:

All connection pipes are enclosed within the base unit.

Water supply lines are routed into the unit via circle opening on the back of the base.

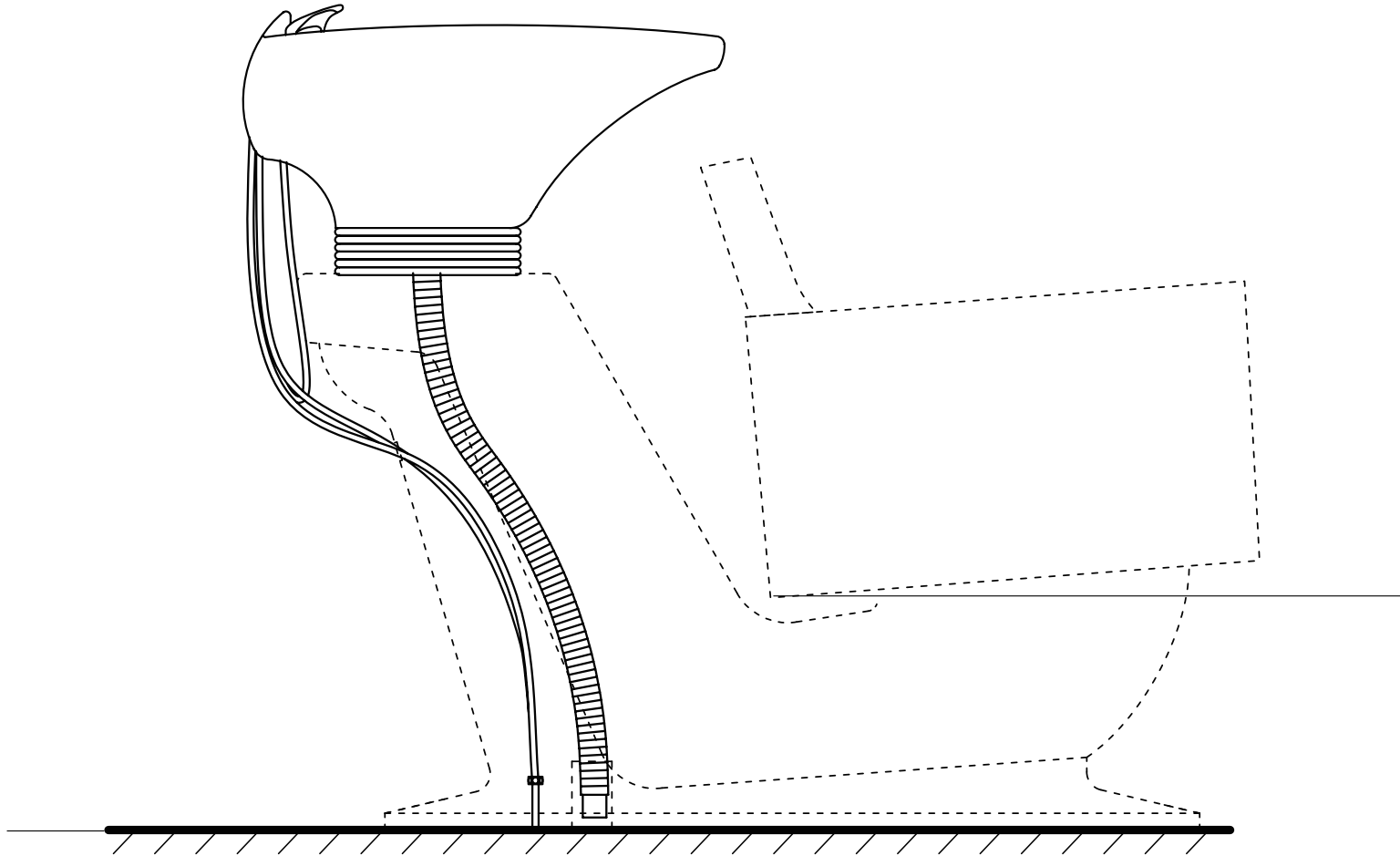

Secure the backwash on the floor by the provided floor anchors.

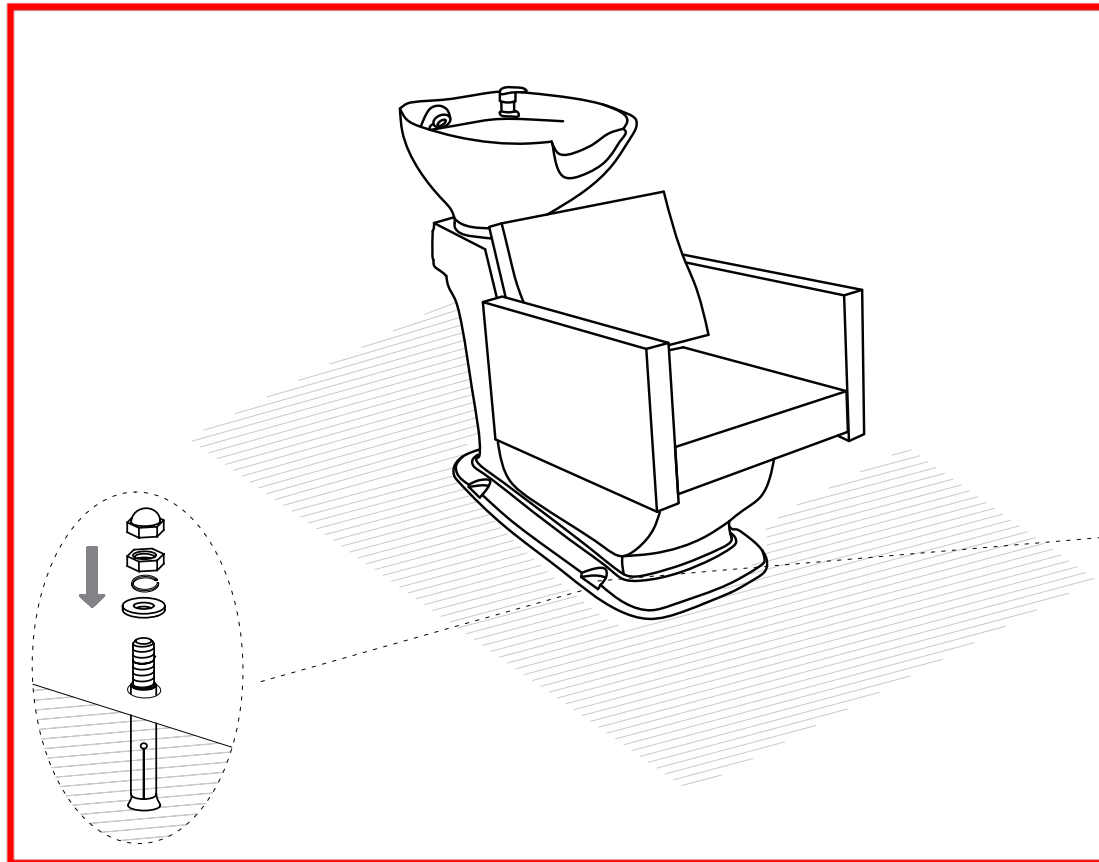



Brush away excess hair

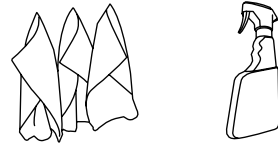

Clean surface with damp cloth or use simple soap & water solution.

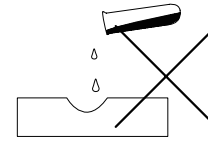

Avoid using corrosive cleaning agents such as bleaches.

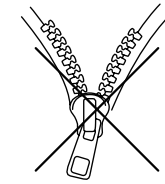

Do not remove upholstery for cleaning

Warranty Coverage:

This warranty is valid for 6 months from the date of purchase. It covers technical problems that occur under normal usage conditions. Technical problems include, but are not limited to, manufacturing defects, hardware malfunctions, and software errors.

Exclusions from Warranty Coverage:

This warranty does not cover any damage or problems caused by user error.

Situations not covered include, but are not limited to:

- Accidental damage or misuse
- Unauthorized repairs or modifications
- Damage resulting from improper handling or storage
- Issues caused by neglect or failure to follow the provided instructions
- Damage due to external factors such as power surges, extreme environmental conditions, or natural disasters.



ESON DIRECT UK LTD.

UNIT 3G, PLYMOUTH RD,
NORTH SHIELDS NE29 7TY

Email: sales@esondirect.co.uk

Phone: +44 191 447 9589